

PTFE Filament Conduit for LACK Enclosure



fuchsr

[VIEW IN BROWSER](#)

updated 3. 11. 2023 | published 3. 11. 2023

Summary

For v1 and v2 LACK enclosure, to feed filament from the top without the excruciating scratching noise. Mk3/4 and Mini.

[3D Printers](#) > [Accessories](#)

Tags: [filamentguide](#)

Most filament guides I found were just plastic conduits through the lid, and in my experience the filament scratching across the plastic gets amplified like crazy by the enclosure.

So I came up with this idea of running a PTFE tube through a conduit. It requires a PC4-M10 or PC4-M8 pneumatic fitting to ensure the PTFE stays in place. This way it is easy to remove the tube when you need to take the printer out of the enclosure. I use it with both, Minis and Mk3S/Mk4 printers.

Two versions included, one for the unmodified LACK lid, one with the cutout for the MMU2.

UPDATE 12-18-2022: While the PC4-M10 push-through version works fine for me, on the Mini I sometimes ended up with a slipping PTFE tube so I added a PC4-M8 version (not push-through). I put the conduit in with the PC4 fitting on the inside of the enclosure and connect it to the PTFE tube

leading to the extruder/filament sensor, then put a short 3 or 4 inch piece of PTFE tube in the other end of the conduit, outside of the enclosure.

If you like what I'm doing...

...consider [buying me a coffee](#).



Print instructions

I printed it in Prusament PETG, 0.2 mm layer height, 15% infill, no supports.

To install, drill a 0.5 inch hole into the lid of the LACK enclosure. Screw a PC4-M10 fitting (e.g., <https://amazon.com/gp/product/B01IB81IHG/>) or PC4-M8 fitting into the bottom-part. Insert it from below into the hole you just drilled and secure it from above with the top-part.

For the Mini, replace the PTFE tube to the extruder or the short stub at the filament sensor with a long piece of PTFE and push it from below through the fitting and cut to size. For the MK3S/Mk4 I just use a small piece of PTFE, maybe four, five inches wide.

To remove the tube, just push down on the black collet and pull the tube out.

Model files

 **Shared** 1 file

 **top-part.stl**

 **PC4-M10** 4 files



bottom-part-long-pc4-m10.stl

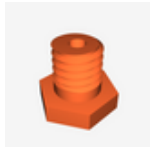

bottom-part-short-pc4-m10.stl



ptfe-lack-conduit.3mf



ptfe-lack-conduit-mmu2-lid.3mf



PC4-M8

2 files



bottom-part-long-pc4-m8.stl



bottom-part-short-pc4-m8.stl

License ©

This work is licensed under a
[Creative Commons \(4.0 International License\)](https://creativecommons.org/licenses/by-nc-sa/4.0/)



Attribution—Noncommercial—Share Alike

- ✗ | Sharing without ATTRIBUTION
- ✓ | Remix Culture allowed
- ✗ | Commercial Use
- ✗ | Free Cultural Works
- ✗ | Meets Open Definition